

NPS Form 10-900  
(Rev. 8-86)

OMB No. 1024-0018

United States Department of the Interior  
National Park Service



**NATIONAL REGISTER OF HISTORIC PLACES  
REGISTRATION FORM**

**NATIONAL  
REGISTER**

**1. NAME OF PROPERTY**

*Historic name:* Caldwell Hall

*Other name/site number:* 62

**2. LOCATION**

*Street & number:* Hardin-Simmons University Campus

*not for publication:* N/A

*City/town:* Abilene

*State:* TX     *County:* Taylor

*code:* 441     *zip code:* 79698

**3. CLASSIFICATION**

*Ownership of Property:* Private

*Category of Property:* Building

<i>Number of Resources within Property:</i>	<i>Contributing</i>	<i>Noncontributing</i>
	<u>  1  </u>	<u>      </u> buildings
	<u>      </u>	<u>      </u> sites
	<u>      </u>	<u>      </u> structures
	<u>      </u>	<u>      </u> objects
	<u>  1  </u>	<u>  0  </u> Total

*Number of contributing resources previously listed in the National Register:* 0

*Name of related multiple property listing:* Historic and Architectural Resources in Abilene, Texas

4. STATE/FEDERAL AGENCY CERTIFICATION

As the designated authority under the National Historic Preservation Act of 1986, as amended, I hereby certify that this   x   nomination    request for determination of eligibility meets the documentation standards for registering properties in the National Register of Historic Places and meets the procedural and professional requirements set forth in 36 CFR Part 60. In my opinion, the property   x   meets    does not meet the National Register criteria.

   See continuation sheet.

   *Carlin J. Russell*

   2-12-92

Signature of certifying official

Date

State Historic Preservation Officer, Texas Historical Commission

State or Federal agency and bureau

In my opinion, the property    meets    does not meet the National Register criteria.

   See continuation sheet.

Signature of commenting or other official

Date

State or Federal agency and bureau

5. NATIONAL PARK SERVICE CERTIFICATION

I, hereby certify that this property is:

    entered in the National Register  
   See continuation sheet.

   *Antoniotti Office*

   3/23/92

   determined eligible for the National Register  
   See continuation sheet.

   determined not eligible for the National Register

   removed from the National Register

   other (explain):

   *fa*

Signature of the Keeper

Date of Action

**6. FUNCTION OR USE**

---

*Historic:* Education                      Sub: College

*Current:* Education                      Sub: College

---

**7. DESCRIPTION**

---

*Architectural Classification:* Classical Revival

<i>Materials: foundation</i>	concrete
<i>walls</i>	brick
<i>roof</i>	asphalt
<i>other</i>	terra cotta

*Describe present and historic physical appearance.  See continuation sheet.*

---

**8. STATEMENT OF SIGNIFICANCE**

---

*Certifying official has considered the significance of this property in relation to other properties: locally*

*Applicable National Register Criteria:* A and C

*Criteria Considerations (Exceptions) :* N/A

*Area(s) of Significance:* Social History and Architecture

*Period(s) of Significance:* 1922-1939

*Significant Dates:* 1922

*Significant Person(s):* N/A

*Cultural Affiliation:* N/A

*Architect/Builder:* unknown

*State significance of property, and justify criteria, criteria considerations, and areas and periods of significance noted above.  See continuation sheet.*

United States Department of the Interior  
National Park ServiceNational Register of Historic Places  
Continuation SheetSection number 7/8 Page 5Historic and Architectural Resources  
of Abilene, Taylor County, Texas

## Description:

Caldwell Hall, a stately 3-story, institutional building on the Hardin-Simmons University campus, is constructed of load bearing masonry. The building, which utilizes an open subdivided plan, rests on a concrete foundation and has an attic story (parapet) that conceals the building's flat roof. It exhibits characteristics associated with Classical Revival (or Beaux Arts Classicism) architecture, including giant order Corinthian pilasters, rusticated first story, and pedimented entrances.

The front (south) facade is symmetrically designed. A plastered water table serves as a sill for windows on the ground floor. A richly ornamented, hooded architrave forms the surround of the centered main entrance doors. The flat arched windows on the front elevation have a 9/1 light configuration. The original windows were replaced with modern aluminum frame windows in 1962.

A wide, continuous, string course above the ground floor acts as a pedestal for six, equidistant fluted Corinthian pilasters. The pilasters rise for two floors and terminate at another continuous string course, which becomes the architrave in the building's entablature. Cartouches flank some of the third floor windows and a brick soldier course lintel interrupted by a keystone further accents these windows. Above the architrave is a decorated frieze capped by a cornice embellished with a modillion band, dentil course, parapet cartouches and molded coping.

A small 1-story rear addition and other interior improvements were completed in 1962.

## Statement of Significance:

Caldwell Hall, constructed in 1922, on the campus of Hardin-Simmons University is nominated under Criterion A in the area of Social History, for its contributions to educational efforts in Abilene. Funds for its construction came from Clifton M. Caldwell, a strong supporter of the institution, and its presence is representative of the philanthropic tendencies of Abilene's wealthiest citizens. It is also nominated under Criterion C in the area of Architecture, as an outstanding example of Classical Revival architecture. The building is associated with the historic context "Educational Efforts in Abilene, 1881-1939." The building is in good condition and retains its integrity.

Hardin-Simmons University, like Abilene, experienced tremendous growth during the 1920s and many buildings were erected during the decade. Caldwell Hall is the least altered and best preserved historic building on the campus. Clifton M. Caldwell, an attorney from

United States Department of the Interior  
National Park Service

**National Register of Historic Places  
Continuation Sheet**

Section number 8 Page 6

Historic and Architectural Resources  
of Abilene, Taylor County, Texas

---

Breckenridge who made wise land and oil investments during the oil boom there in 1919, gave Hardin-Simmons \$100,000 for the construction of the building. Caldwell, besides being a strong supporter of education in general, apparently was a great lover of music and he owned a music store that is still in operation at today. Thus, it is not surprising that the money he gave the college went toward the construction of a Fine Arts building. (When Caldwell moved to Abilene in the early 1920s, he erected a majestic Prairie School-influenced house at the southwest corner of Orange and North 8th streets, a Contributing property in the Parramore Historic District (National Register 1991).

Caldwell Hall exhibits characteristics associated with Classical Revival architecture, including its giant order Corinthian pilasters, rusticated first story, and pedimented entrances.

The only alterations that detract from Caldwell Hall's architectural integrity are the replacement of the original wood sash windows, the construction of a small 1-story rear addition and the completion other interior improvements completed in 1962. Despite these changes, the building retains much of its historic character and is the most intact historic building on the campus of Hardin-Simmons University.

**9. MAJOR BIBLIOGRAPHICAL REFERENCES**

x See bibliography for associated historic context.

Previous documentation on file (NPS): N/A

- preliminary determination of individual listing (36 CFR 67) has been requested.
- previously listed in the National Register
- previously determined eligible by the National Register
- designated a National Historic Landmark
- recorded by Historic American Buildings Survey #
- recorded by Historic American Engineering Record #

Primary Location of Additional Data:

- State historic preservation office (Texas Historical Commission)
- Other state agency
- Federal agency
- Local government (City of Abilene Planning Department)
- University
- Other -- Specify Repository: Abilene Preservation League

**10. GEOGRAPHICAL DATA**

Acreege of Property: Less than one acre

UTM References: Zone Easting Northing    Zone Easting Northing

A	14	430920	3593420	B	___	_____	_____
C	___	_____	_____	D	___	_____	_____

Verbal Boundary Description:

The boundary is indicated on the accompanying base map, see attached Continuation Sheet 10-7.

Boundary Justification:

The boundary includes the area that has been historically associated with the property and that retains its historic and architectural integrity.

**11. FORM PREPARED BY** (assisted by Amy E. Dase, Historian, THC staff)

Name/Title: David Moore, Historian  
 Organization: Hardy Heck Moore  
 Street & Number: 2112 Rio Grande  
 City or town: Austin

Date: June 1989; January 1992  
 Telephone: 512/478-8014  
 State: TX Zip: 78705

United States Department of the Interior  
National Park Service

# National Register of Historic Places Continuation Sheet

Section number 10 Page 7

Historic and Architectural Resources  
of Abilene, Taylor County, Texas

VOGEL AVE.

INTRACAMPUS DR.

CALDWELL HALL

BOUNDARY

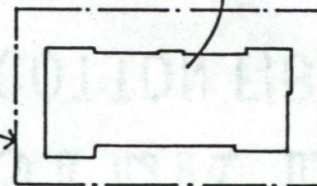

INTRACAMPUS DR.



NORTH

CALDWELL HALL  
HARDIN-SIMMONS UNIVERSITY  
ABILENE, TEXAS

SCALE: 1" = APPX. 75'

United States Department of the Interior  
National Park Service

**National Register of Historic Places  
Continuation Sheet**

Section number \_\_\_\_\_ PHOTOS \_\_\_\_\_ Page 4

Historic and Architectural Resources  
of Abilene, Taylor County, Texas

---

Abilene Streetcar Railway Company Barn  
1037 Clinton  
Abilene, Taylor County, Texas  
Photographed by David Moore  
Winter 1989  
Negative with Texas Historical Commission  
Southwest oblique, camera facing northeast  
Photograph 13 of 48

**Caldwell Hall**

Hardin-Simmons University Campus  
Abilene, Taylor County, Texas  
Photographed by David Moore  
Winter 1989  
Negative with Texas Historical Commission  
Southwest oblique, camera facing northeast  
Photograph 14 of 48

William J. Fulwiler House  
910 Highland  
Abilene, Taylor County, Texas  
Photographed by Abilene Preservation League  
Spring 1988  
Negative with Texas Historical Commission  
East facade, camera facing west  
Photograph 15 of 48

Roland A.D. Green House  
1358 Highland  
Abilene, Taylor County, Texas  
Photographed by David Moore  
Winter 1989  
Negative with Texas Historical Commission  
East facade, camera facing west  
Photograph 16 of 48



2/19/92

United States Department of the Interior  
National Park Service

National Register of Historic Places  
Continuation Sheet

Section number \_\_\_\_\_ Page \_\_\_\_\_

Abilene MPS  
TEXAS

		Date Listed
COVER	<del>Substantive Review</del>	12/18/91
92000225	1915 Taylor County Courthouse	3/23/92
92000193	Abilene Christian College Administration Building	3/23/92
91001811	Abilene Commercial Historic District	12/18/91
92000200	Abilene Fire Station No. 2	3/23/92
92000205	Abilene Street Railway Company Barn	3/23/92
92000191	Abilene and Northern Railway Company Depot <i>unnecessary</i>	3/23/92
92000214	Ackers, William and Mary, House	3/23/92
92000234	Blanton, Thomas L., House <u>Substantive Review</u>	3/23/92
92000229	Boyd--Hall House	3/23/92
92000206	Caldwell Hall <u>Substantive Review</u>	3/23/92
92000195	Cash, W. A. V., House <u>Substantive Review</u>	3/23/92
92000218	Castle, David S., House <u>Substantive Review</u>	3/23/92
92000211	Chambers, Samuel A., House	3/23/92
92000237	Davis, George R., House	3/23/92
92000199	Dillingham, O. D. and Ada, House	3/23/92
92000222	Dodd--Harkrider House <u>Substantive Review</u>	3/23/92
92000204	Evans, J. W., House	3/23/92
92000228	Federal Building ( <i>now returned</i> )	Ret.
92000210	Finley, Eugene L., House	3/23/92
92000226	First Presbyterian Church <u>Substantive Review</u>	3/23/92
92000215	Fritz, David C. and Docia, House	3/23/92
92000192	Fulwiler, William J., House <i>unnecessary</i> <u>Substantive Review</u>	3/23/92
92000232	Goodloe, Albert S. and Ruth, House	3/23/92
92000207	Green, Roland A. D., House	3/23/92
92000236	Higginbotham, J. G., House	3/23/92
92000196	House at 1127 Ash Street	3/23/92
92000224	Hughes, Ed S., Company Warehouse	3/23/92
92000212	Jones, A. T., House	3/23/92
92000221	Lanius, C. A., House <u>Substantive Review</u>	3/23/92
92000194	Luce Hall <u>Substantive Review</u>	3/23/92
92000220	Magee, J. D., House	3/23/92
92000201	McDaniel, George W. and Lavina, House	3/23/92
92000219	McDonald Hall	3/23/92
92000209	McMurry College Administration Building <u>Substantive Review</u>	3/23/92
92000198	Minter, William A., House	3/23/92
92000216	Motz, Charles, House	3/23/92
92000230	Parramore, D. D., House	3/23/92
92000223	Radford, James M., Grocery Company Warehouse	3/23/92
92000231	Reading, Jhules, House	3/23/92
92000235	Roberts, Nathan J. and Nancy, House	3/23/92
92000233	Sacred Heart Catholic Church	3/23/92

United States Department of the Interior  
National Park Service

# National Register of Historic Places Continuation Sheet

Section number \_\_\_\_\_ Page \_\_\_\_\_

### SUPPLEMENTARY LISTING RECORD

NRIS Reference Number: 92000206 Date Listed: 3/23/92

Caldwell Hall  
Property Name

Taylor                      TX  
County                      State

Abilene MPS  
Multiple Name

-----  
This property is listed in the National Register of Historic Places in accordance with the attached nomination documentation subject to the following exceptions, exclusions, or amendments, notwithstanding the National Park Service certification included in the nomination documentation.

*Annunzio J. Lee*  
Signature of the Keeper

3/26/92  
Date of Action

=====

#### Amended Items in Nomination:

**Statement of Significance:** Under Areas of Significance, Education is added.

This information was confirmed with Amy Daze of the Texas State historic preservation office.

#### DISTRIBUTION:

- National Register property file
- Nominating Authority (without nomination attachment)

UNITED STATES DEPARTMENT OF THE INTERIOR  
NATIONAL PARK SERVICE

NATIONAL REGISTER OF HISTORIC PLACES  
EVALUATION/RETURN SHEET

REQUESTED ACTION: NOMINATION

PROPERTY Caldwell Hall  
NAME:

MULTIPLE Abilene MPS  
NAME:

STATE & COUNTY: TEXAS, Taylor

DATE RECEIVED: 2/19/92 DATE OF PENDING LIST: 3/06/92  
DATE OF 16TH DAY: 3/22/92 DATE OF 45TH DAY: 4/04/92  
DATE OF WEEKLY LIST:

REFERENCE NUMBER: 92000206

NOMINATOR: STATE

REASONS FOR REVIEW:

APPEAL: N DATA PROBLEM: N LANDSCAPE: N LESS THAN 50 YEARS: N  
OTHER: N PDIL: N PERIOD: N PROGRAM UNAPPROVED: N  
REQUEST: N SAMPLE: N SLR DRAFT:  NATIONAL: N

COMMENT WAIVER: N

ACCEPT  RETURN  REJECT 3/23/92 DATE

ABSTRACT/SUMMARY COMMENTS:

*Caldwell Hall is significant as representative of local educational efforts and as an important example of Classical Revival Architecture in the community.*

RECOM./CRITERIA Accept 1A+C  
REVIEWER Christine J. Lee  
DISCIPLINE History  
DATE 3/22/92

DOCUMENTATION see attached comments Y/N see attached SLR <sup>3/22/92</sup>  N

CLASSIFICATION

\_\_\_count \_\_\_resource type

STATE/FEDERAL AGENCY CERTIFICATION

FUNCTION

\_\_\_historic \_\_\_current

DESCRIPTION

\_\_\_architectural classification  
\_\_\_materials  
\_\_\_descriptive text

SIGNIFICANCE

Period Areas of Significance--Check and justify below

Specific dates Builder/Architect  
Statement of Significance (in one paragraph)

- \_\_\_summary paragraph
- \_\_\_completeness
- \_\_\_clarity
- \_\_\_applicable criteria
- \_\_\_justification of areas checked
- \_\_\_relating significance to the resource
- \_\_\_context
- \_\_\_relationship of integrity to significance
- \_\_\_justification of exception
- \_\_\_other

BIBLIOGRAPHY

GEOGRAPHICAL DATA

\_\_\_acreage \_\_\_verbal boundary description  
\_\_\_UTMs \_\_\_boundary justification

ACCOMPANYING DOCUMENTATION/PRESENTATION

\_\_\_sketch maps \_\_\_USGS maps \_\_\_photographs \_\_\_presentation

OTHER COMMENTS

Questions concerning this nomination may be directed to

\_\_\_\_\_  
Phone \_\_\_\_\_

Signed \_\_\_\_\_ Date \_\_\_\_\_



CALDWELL HALL  
HARDIN-SIMMONS UNIVERSITY CAMPUS  
ABILENE, TAYLOR CO., TEXAS

PHOTOGRAPH 14 of 48

Please refer to the map in the  
Multiple Property Cover Sheet  
for this property

Multiple Property Cover Sheet Reference Number: 64500625